

Multi-Jet Water Meters

5/8", 3/4" and 1"



5/8" x 3/4"



1" Frost Proof

T E C H N I C A L S P E C I F I C A T I O N S

AWWA Standard	Meets or exceeds all sections of AWWA Standard C-708, most recent revision.
Design/Operation	Velocity-type meter. Water, evenly distributed by multiple jet nozzles, flows past an impeller in the measuring chamber, creating an impeller velocity directly proportional to water flow rate. The meter's register integrates velocity into totalized flow.
Main Case	Choice of waterworks bronze case of 81% copper composition or SeBILOY® II, 87% copper, low lead bronze. All main cases incorporate externally threaded ends and wrench pads to aid installation. Bronze register retaining rings are standard.
Measuring Chamber	The measuring chamber housing and measurement element are constructed of a durable synthetic polymer and can easily be removed from the main case without removal of the meter from the line. The chamber housing is constructed in two parts to allow access to the impeller. Measurement surfaces are not wear surfaces, providing sustained accuracy despite the presence of entrained solids in the water. A long-life, sapphire serves as a wear surface, with balanced water flows minimizing bearing wear.
<i>Magnetic Drive</i>	A reliable, direct magnetic drive provides linkage between measurement element and register. No intermediate gearing is required; no gearing is exposed to water.
Register	Standard direct read, DIALOG® Reading System and Electrical Output Registers are available. A six wheel odometer is standard.
<i>Register Sealing</i>	Direct read and DIALOG registers are permanently sealed, with a tempered glass lens, stainless steel base and wrap-around gasket to prevent intrusion of dirt or moisture.
<i>Register Units</i>	Registration available in gallons, cubic feet or cubic metres.
<i>Test Circle</i>	Large center sweep hand with ten clearly indicated gradations per minimum registration unit.
<i>Low Flow/Leak Indicator</i>	Center mounted indicator with high sensitivity resulting from direct one to one linkage to the measuring element.
Strainer	A rugged, 360-degree polymer basket strainer protects the critical measuring element from damage.
Frost Protection (option)	Patented, pressure-activated plug is expelled from the meter by expansion of freezing water. The frost plug can be replaced without meter removal or disassembly.
Adjusting Port	Sealed after factory calibration. Port is accessible for utility recalibration, to compensate for inaccuracy in older meters without parts replacement.
Tamper Detection	The Master Meter Multi-Jet adjusting port is sealed to prevent tampering and provides a visual indication of tampering attempts.



Meter Operating Characteristics and Dimensions

5/8", 3/4" and 1" Multi-Jet Meters

Characteristic/Dimension	5/8"	5/8" x 3/4"	3/4" SL	3/4"	3/4" x 1"	1"
Flow Rating (gpm)	20	20	30	30	30	50
Continuous Flow (gpm)	15	15	20	20	20	30
Normal Flow Range (gpm)	1-20	1-20	2-30	2-30	2-30	3-50
Low Flow (gpm)	1/4	1/4	1/2	1/2	1/2	3/4
Maximum Working Pressure (psi)	150	150	150	150	150	150
Maximum Working Temperature (F)	122	122	122	122	122	122
Length (A below)	7-1/2"	7-1/2"	7-1/2"	9.0"	9.0"	10-3/4"
Width (B below)	3-3/4"	3-3/4"	3-3/4"	3-3/4"	3-3/4"	4-1/8"
Width, side-mounted DIALOG unit	4-1/2"	4-1/2"	4-1/2"	4-1/2"	4-1/2"	4-1/2"
Height, standard register with lid (C below)	4-1/8"	4-1/8"	4-1/8"	4-1/8"	4-1/8"	3-7/8"
Height with DIALOG register	4-7/8"	4-7/8"	4-7/8"	4-7/8"	4-7/8"	4-5/8"
Height, Frost Proof, standard register with lid 4-3/8" (F below)	4-3/8"	4-3/8"	4-3/8"	NA	NA	4-3/8"
Height, bottom to center line (D below)	1-3/16"	1-3/16"	1-3/16"	1-3/16"	1-3/16"	1-3/16"
Height, Frost Proof, bottom to center line (G below)	1-3/4"	1-3/4"	1-3/4"	1-3/4"	1-3/4"	1-3/4"
Meter Casing Spuds, Nominal Thread Size* (E below)	3/4"	1"	1"	1"	1-1/4"	1-1/4"
Weight (pounds)	4	4	4	4-1/4	4-1/4	5
Packed To Carton	12	12	12	8	8	8
Carton Weight (pounds)	50	50	50	35	35	41

*External Straight Threads

Standard 5/8" to 1" Multi-jet Meter

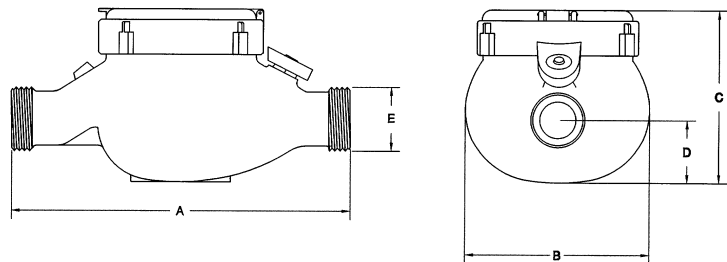

Frost Proof 5/8" to 1" Multi-jet Meter

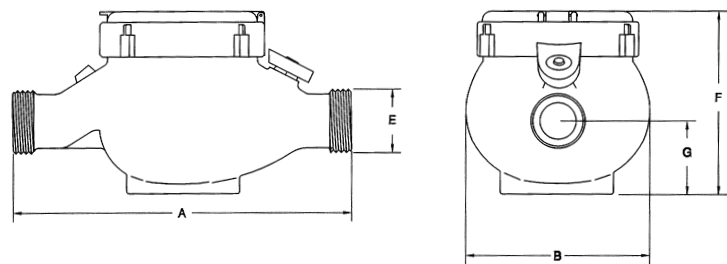

100 E. 15th Street, Suite 350
 Fort Worth, TX 76102
 800-765-6518
 817-336-3837 (817-33-METER)
 FAX: 817-336-3840
 e-mail: sales@mastermeterinc.com

Distributed by:

