

Series 2150 - Solenoid Valve



Conduit

- 1/4" Solenoid Valve
- Direct Acting
- Integral Strainer
- Optional Flow Control
- UL Listed
- Maximum Temperature 140° F
- Pressure Range 0 -150 psi
- Horizontal or Vertical Installation



Appliance

SPECIAL FEATURES

Trouble free performance

Electro-Mite is designed for continuous or intermittent operation with minimal down time or maintenance.

Constant flow rate

With a variable pressure range the Electro-Mite with the innovative Hays Flow Control will deliver a constant flow rate.

Mount in any position

Gives flexibility to placement so that valve may be positioned to the task.

Highest quality . . . long life

Using the highest quality in terms of component materials, and production technology each Electro-Mite will provide outstanding performance for a long period.

Wide range of voltages

Hays Electro-Mite gives a large selection of voltages to achieve the desired results.

TYPICAL APPLICATIONS

- Poultry Equipment
 - Sterilizers
- Heating Systems
- Washing Machines
- Car Wash Equipment
- Spraying Equipment
- Laboratory Equipment
 - Humidification

TO ORDER ELECTRO-MITE

Specify: model, coil type, voltage, & flow rate

Model Series #	Strainer	Flow Control	Mounting Bosses	Elastomers
2154	Yes	No	No	Buna N and Ethylene Propylene
2156	Yes	No	Yes	Buna N and Ethylene Propylene
2157	Yes	Yes	Yes	Buna N and Ethylene Propylene
2167	Yes	Yes	Yes	Viton and Ethylene Propylene

		Flow Rates									
Coil Type	Voltage	2/10	1/4	3/10	4/10	1/2	5/10	7/10	3/4	1	1 1/4
Conduit	24V	3411	3421	3431	3441	3451	3461	3471	3481	3412	3422
	120V	3011	3021	3031	3041	3051	3061	3071	3081	3012	3022
	208V	3511	3521	3531	3541	3551	3561	3571	3581	3512	3522
	240V	3111	3121	3131	3141	3151	3161	3171	3181	3112	3122
	480V	3211	3221	3231	3241	3251	3261	3271	3281	3212	3222
Appliance	24V	8411	8421	8431	8441	8451	8461	8471	8481	8412	8422
	120V	8011	8021	8031	8041	8051	8061	8071	8081	8012	8022
	208V	8511	8521	8531	8541	8551	8561	8571	8581	8512	8522
	240V	8111	8121	8131	8141	8151	8161	8171	8181	8112	8122
	480V	8211	8221	8231	8241	8251	8261	8271	8281	8212	8222

Example: 1/4" Electro-Mite Valve with Flow Control, with mounting bosses. 120 volt conduit coil and flow rate 1/2 GPM.

Order: 2157 - 3051

TECHNICAL DATA

Dimensions

Conduit

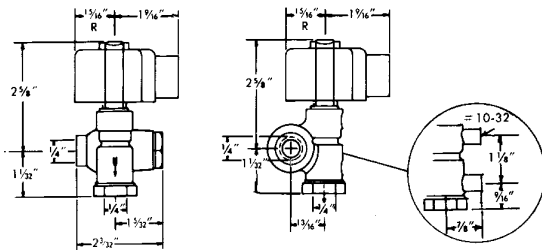

Appliance

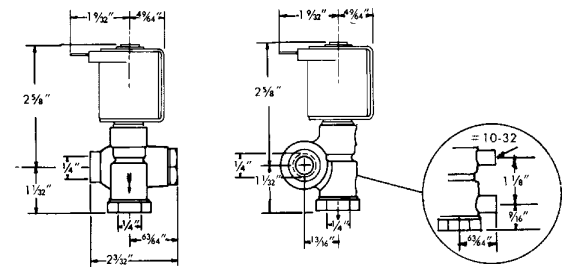

Materials of construction for wetted parts:

2154 and 2156: Bronze, 360 Brass, 302, 305 and 430 F Stainless Steel, Inconel, Teflon, Ethylene Propylene and Buna N.

2157 and 2167: Bronze, 360 Brass, 302, 305 and 430 F Stainless Steel, Inconel, Teflon, Ethylene Propylene and Viton.

FLOW CAPACITY CHARTS

Flow Data with Strainer Only

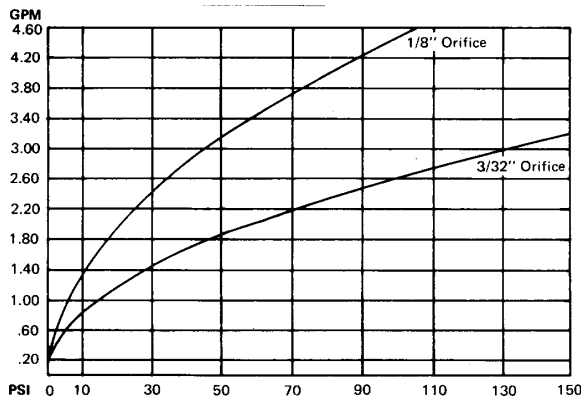

Typical Flow Data with Strainer and Flow Control

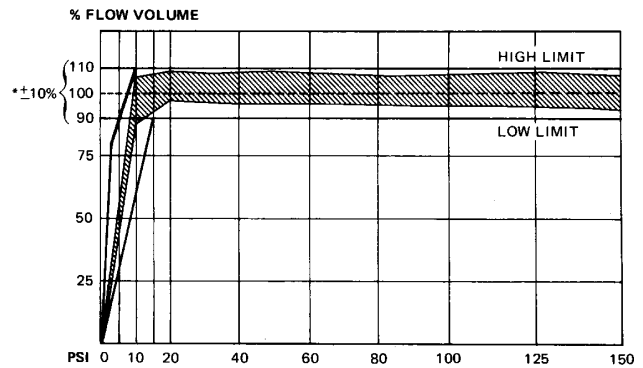

Cv Flow Factor .26 for 2154 & 2156.

* Electro-Mite Valves with Strainer and Flow Control. Direct acting valve with 1/4" F.I.P. inlet & outlet. Valves will deliver flow rates as shown:

GPM (Range)	Pressure Range	Tolerance	Temperature
2/10 - 3/4 GPM	15 - 150 psi	± 10%	180° F
1 — 1 1/4 GPM	0 - 100 psi	± 10%	180° F
Flow Rates (GPM) 2/10, 1/4, 3/10, 4/10, 1/2, 6/10, 7/10, 3/4, 1, 1 1/4			

Solenoid Data	Coil Type	Voltage	Catalog Number	Watts Holding	Volts/Amps. In Rush	Volts/Amps. Holding	Duty
Coils are Epoxy molded & waterproof	Conduit	24V. AC 60 Hz.	74604	14	62	31	Continuous
		120V. AC 60 Hz.	74265	14	62	31	Continuous
		208V. AC 60 Hz.	74268	14	62	31	Continuous
		240V. AC 60 Hz.	74266	14	62	31	Continuous
		480V. AC 60 Hz.	74267	14	62	31	Continuous
	Appliance	24V. AC 60 Hz.	87879	14	80	40	Appliance
		120V. AC 60 Hz.	87859	14	80	40	Appliance
		208V. AC 60 Hz.	87861	14	80	40	Appliance
		240V. AC 60 Hz.	87860	14	80	40	Appliance
		480V. AC 60 Hz.	88500	14	80	40	Appliance

PARTS LIST

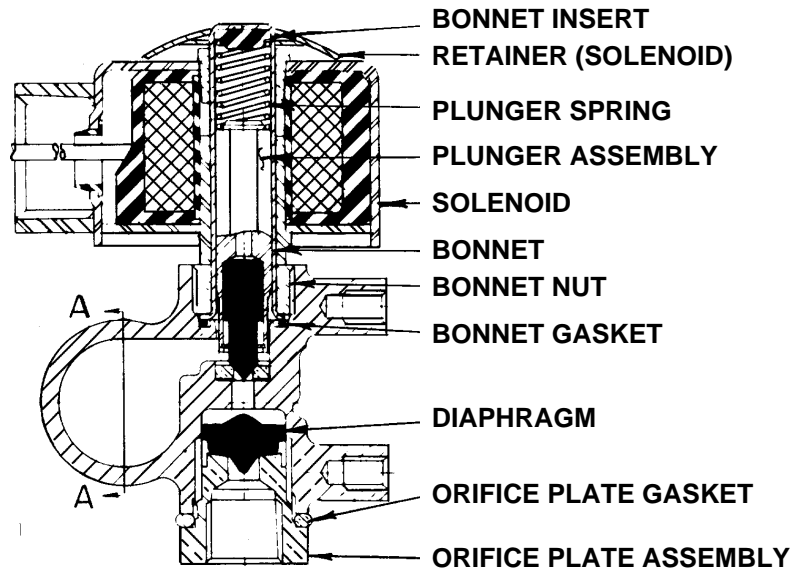
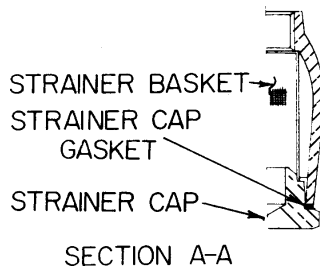

1-30

Part Name	Series 2154, 2156, 2157	Series 2167
	For Water and Air	For Oils and Solvents
	Catalog No.	Catalog No.
Plunger Assembly	*7419706	*7475702
Plunger Spring	*84198	*84198
Bonnet with Bonnet Insert	*7419202	*7419202
Bonnet Nut	*84194	*84194
Bonnet Gasket	*84195	*84818
Retainer	*82958	*82958
Strainer Cap	82948	82948
Strainer Cap Gasket (O-Ring)	86913	88235
Strainer Basket (40 x 40 Mesh)	82950	82950
Strainer Basket (80 x 80 Mesh)	83412	83412
Diaphragm "C"	85685	84666
Orifice Plate Gasket	82224	82224
Spanner Nut Bonnet	*84539	*84539
Orifice Plate Assembly	Consult Factory	Consult Factory

* Repair Kit #11574