

100 East Felix St. South, Suite 190  
Fort Worth, Texas 76115  
817-920-9998  
800-235-1638 • Fax: 817-921-5282  
Www.blancett.com

## Installation & Operation Manual

### QUIKSERT™ TURBINE METER REPAIR KITS

Rev. A

#### GENERAL DESCRIPTION:

The Blancett QuikSert™ turbine flow meter is designed with wear resistant moving parts to provide trouble free operation and long service life. The kit allows easy field repair of a damaged flow meter, rather than replacing the entire flow meter. Repair parts are constructed of stainless steel alloy and tungsten carbide.

Each turbine meter repair kit is factory calibrated to ensure accuracy throughout the entire flow range. Each kit is complete and includes a new K-Factor, which is the calibrated number of pulses generated by each gallon of liquid. This K-factor will be used to recalibrate the monitor, or other electronics, to provide accurate output data.

REPAIR KIT INFORMATION		
Repair Kit Part Number	Flow Meter Size	Repair Kit Fits Meter Part Number
B253-102	3/8" x 1"	B131-038
B253-105	1/2" x 1"	B131-050
B253-108	3/4" x 1"	B131-075
B253-109	7/8" x 1"	B131-088
B253-112	1" x 1"	B131-100
B253-205	1/2" x 2"	B132-050
B253-208	3/4" x 2"	B132-075
B253-209	7/8" x 2"	B132-088
B253-212	1" x 2"	B132-100
B253-216	1-1/2" x 2"	B132-150
B253-220	2" x 2"	B132-200
B253-330	3" x 3"	B133-300
B253-440	4" x 4"	B134-400
B253-660	6" x 6"	B136-600
B253-880	8" x 8"	B138-800
B253-990	10" x 10"	B139-900
B111109	Standard Magnetic Pick-up	All Meter Sizes

## TURBINE METER REMOVAL

**WARNING:** High-pressure leaks are dangerous and cause personal injury. Make sure that fluid flow has been shut off and pressure in the line released before attempting to remove the meter.

## DISASSEMBLY

**Refer to Figures 1, and 2 for relative positions of repair kit components.**

1. Remove the magnetic pick-up from the meter body to avoid damage during repair.
2. Remove the retaining ring from one end of the meter. Note 2" and larger are held in by retaining screws.
3. Remove the rotor support from the body. If the rotor support is jammed in the body, use a pair of pliers or vice-grips to break the rotor support free.
4. The rotor may also be removed at this time.
5. Remove the retaining ring from the opposite side of the meter. Note 2" and larger are held in by retaining screws.
6. Remove the second rotor support.

## INSTALLATION OF NEW KIT:

**IMPORTANT:** Before reassembly, note that an arrow is cast or engraved on each component \*. The arrow indicates the direction of flow. The meter must be reassembled with arrowheads pointed in the direction of the fluid flow. The arrows are to be oriented in the up position on both rotor supports. The magnetic pick-up side of the body signifies the up position. This is the position that the repair kit was calibrated, and this is the position it is to be used to ensure meter accuracy. Figure 1 and 2 shows the proper alignment and orientation of the repair kit.

\* Fractional sizes (3/8", 1/2", 3/4" & 7/8") rotors do not contain a cast or engraved arrow, however Blancett provides a colored cap on the **down stream side** of the rotor shaft to indicate flow direction. Remove this cap before assembly, noting flow direction.

1. Install one of the rotor supports into the body bore, noting the orientation of the arrow.
2. Secure a retaining ring in the groove provided. Be sure that retaining rings are completely installed in each groove. Note: 2" and larger meters will have retaining screws on both ends of the meter (Fig. 2).
3. Insert the rotor and second rotor support in the opposite side of the body, noting the orientation of the arrow.
4. Secure the second retaining ring in the opposite groove, (Note: 2" and larger meters will have retaining screws on both ends of the meter (Fig. 2).
5. Check the meter by blowing air through the assembly. If the rotor does not turn freely, the meter should be disassembled and checked for anything that would obstruct movement of the rotor.

**CAUTION:** Excess air pressure may damage the rotor and bearings by overspinning.

6. Install the magnet pick-up.

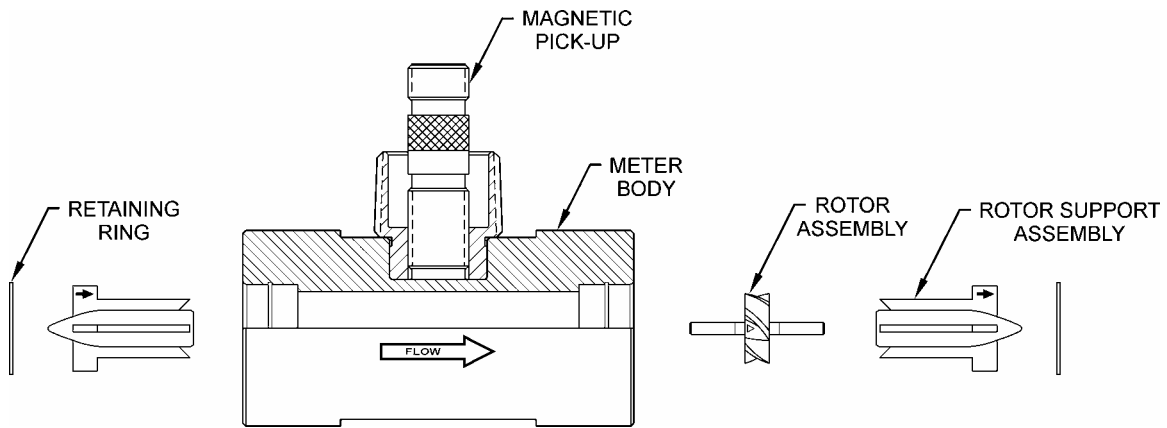

**Figure 1:** Relative positions of internal components for all QuikSert meter sizes B131-038 through B131-100.

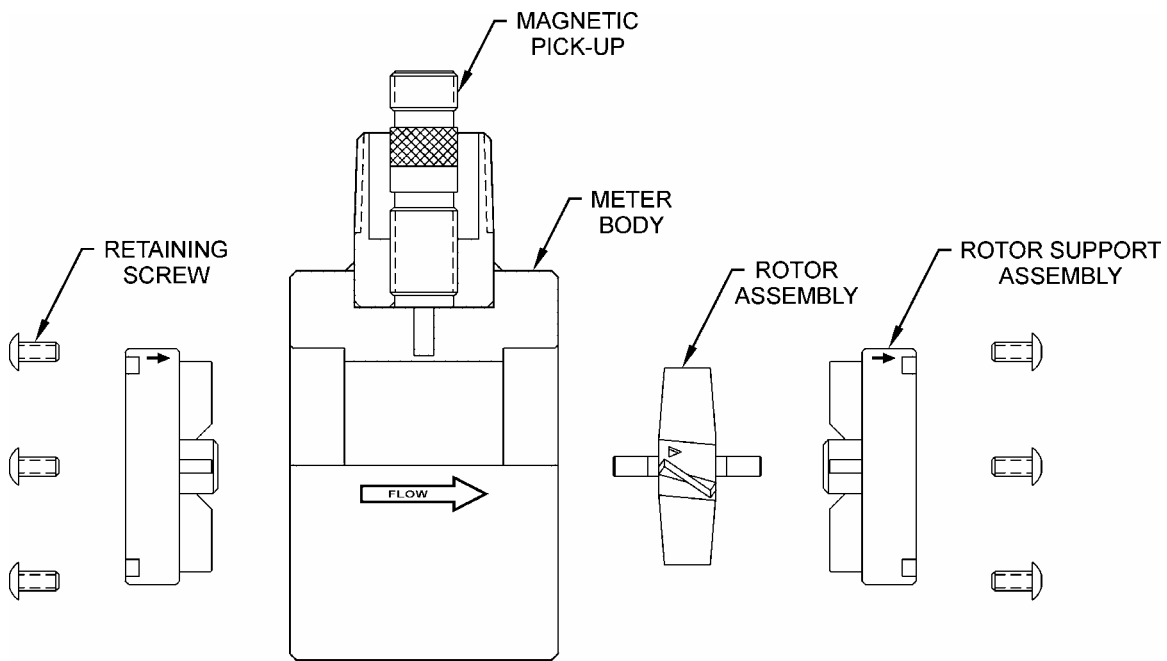

**Figure 2:** Relative positions of internal components for all QuikSert meter sizes B132-050 through B139-900.

**Note:** At this time electronics will need recalibration. Refer to the proper installation and operation manual. If there are any questions on recalibration, contact Blancett factory toll free number 1.800.235.1638, or the manufacturer of the associated electronics.